



# ISO-Plane™

2026 Configuration at start of TRL3



One container. One aircraft. One mission.

# Today, ISO container by Air ?



Aircrafts capable of loading on 20' ISO container are too big (military)  
and need large ground logistic toolings

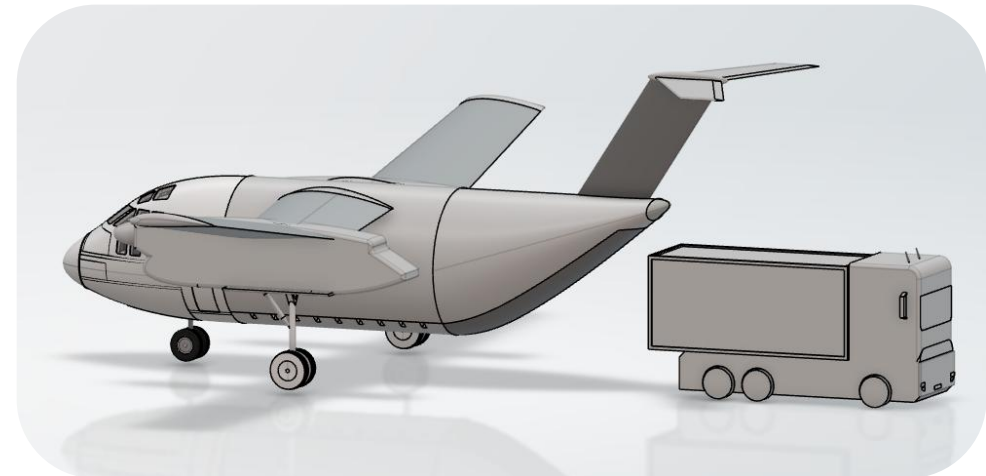

# Objectives of ISO-Plane project



Airplane capable of loading and unloading :

- **One 20feet ISO-Container** of 8 tons
- Directly on a truck trailer or on the **ground**
- On regular landing field
  
- With a crew team of two people, automatic loading
- 6 000 km autonomous range
- Capable of water bombing

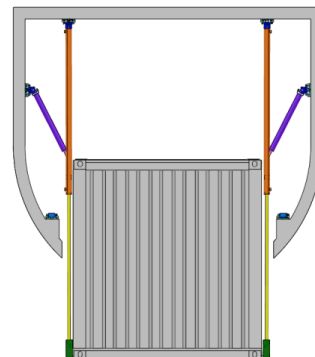
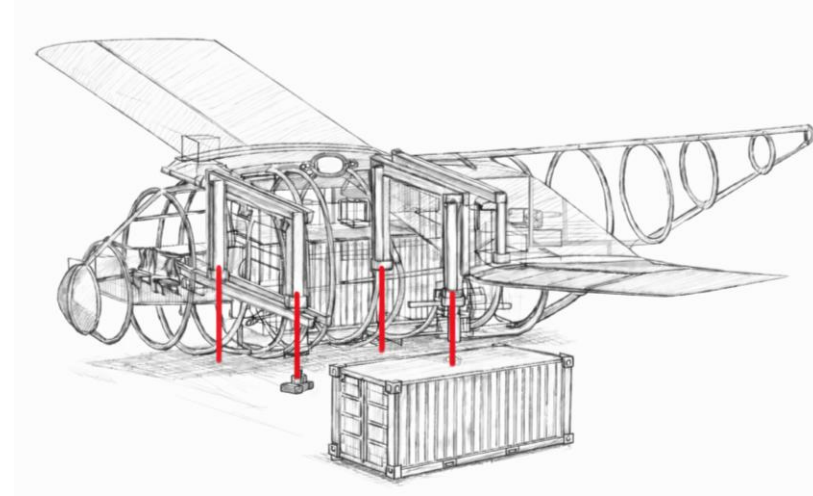

# Missions of ISO-Plane



*Aerial Firefighting*



*Logistics Operations*



*Special Missions /  
Defense Operations*



*Humanitarian Aid /  
Relief Operations*



# ISO-Plane is a collaborative project



- TRL2 achieved in June 2015
- TRL3 in process 2016

## Academics



## Technical coordinator



www.bee-license.com



www.collaborativebee.com

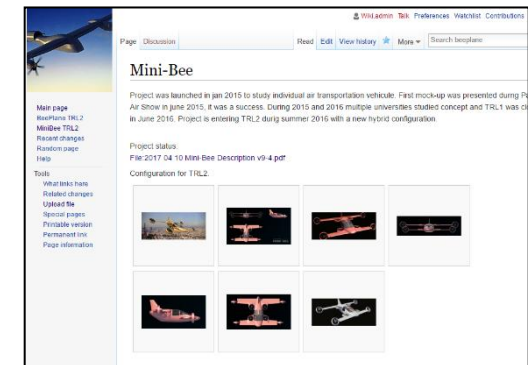

# ISO container, from truck to plane

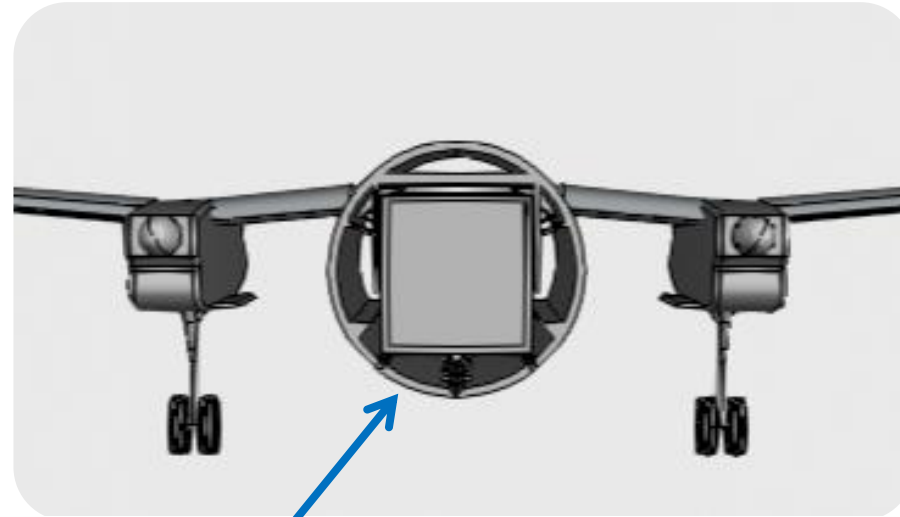
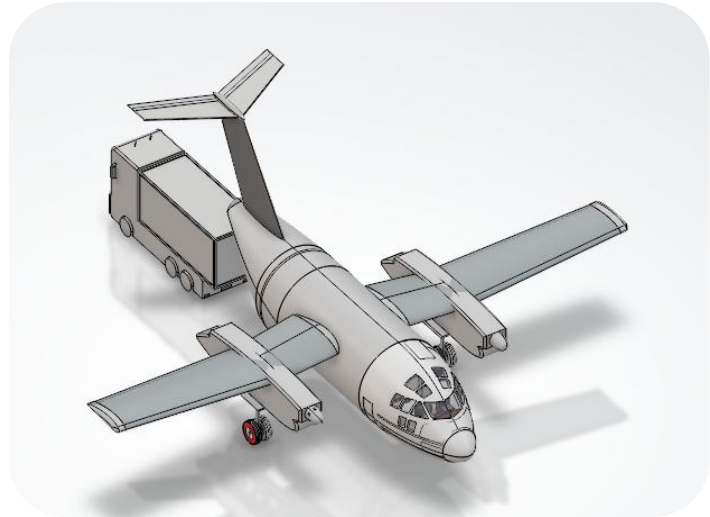

Lower and back container door

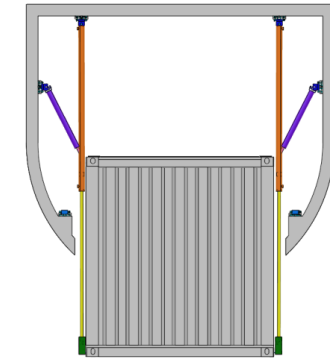

Load and Drop one 20' ISO-container directly on the ground or on a truck trailer

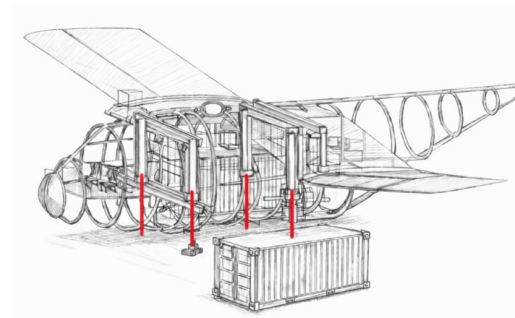

# Focus on the loading system

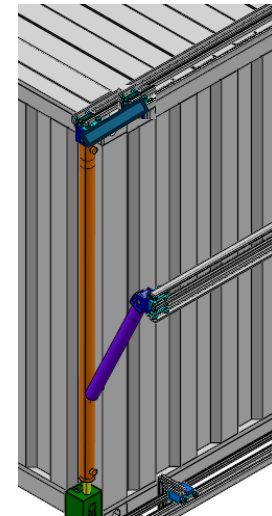
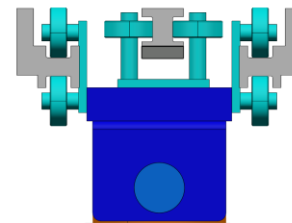
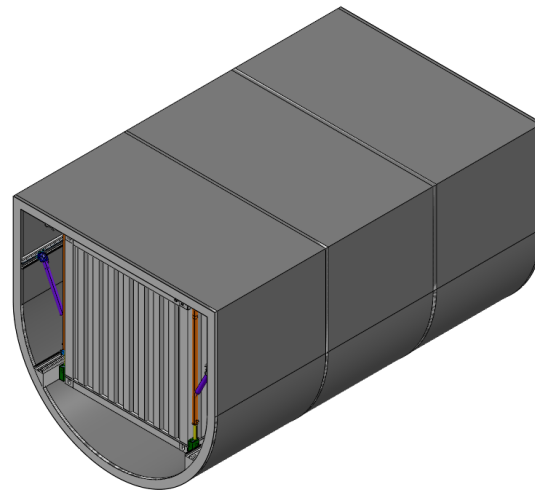
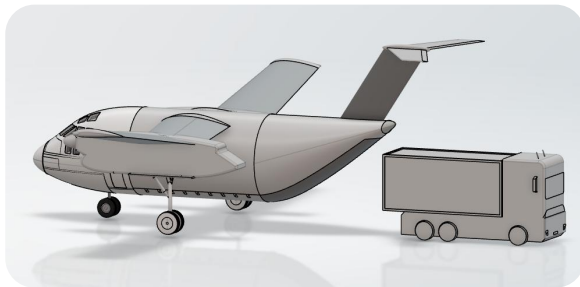
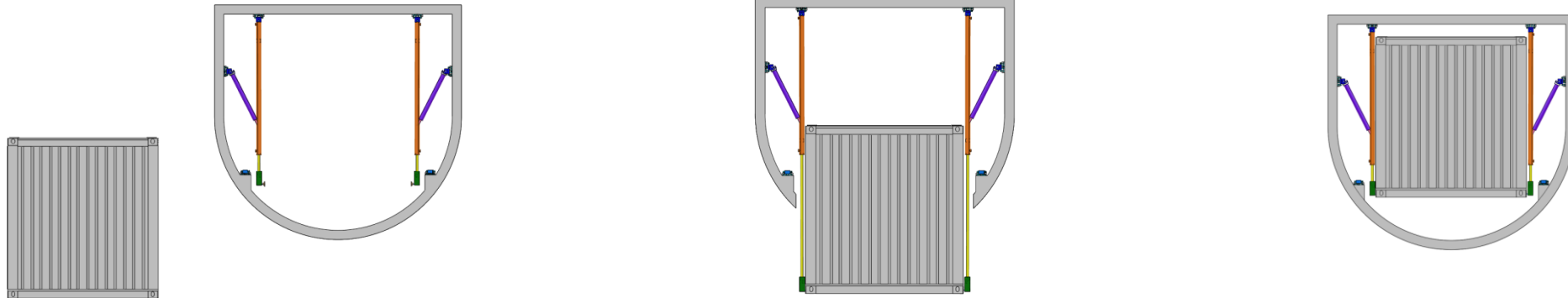

# Focus on the cargo doors

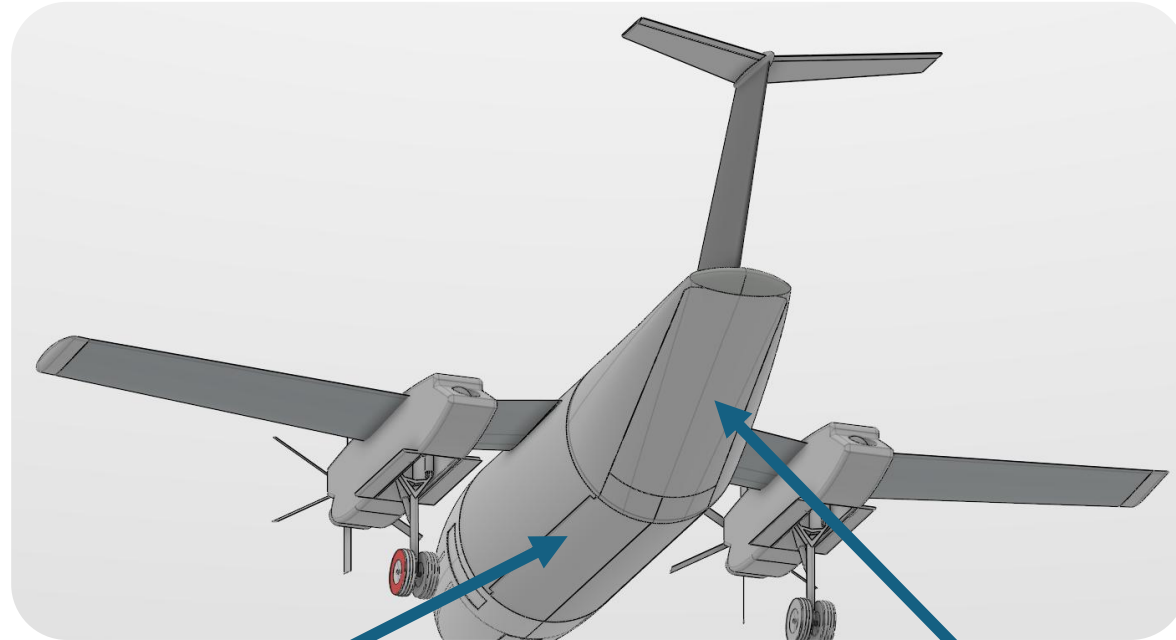
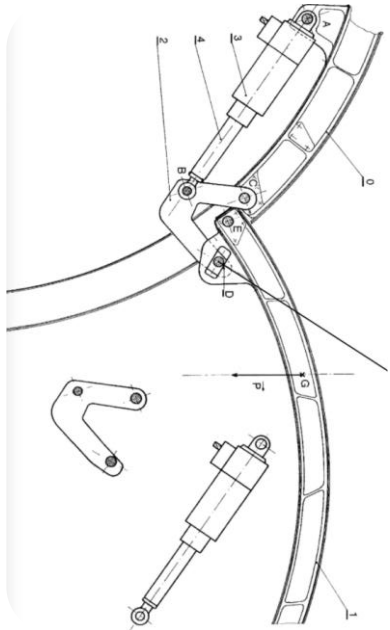

Ventral Doors

Rear doors



C5 Galaxy

# Focus on the engines

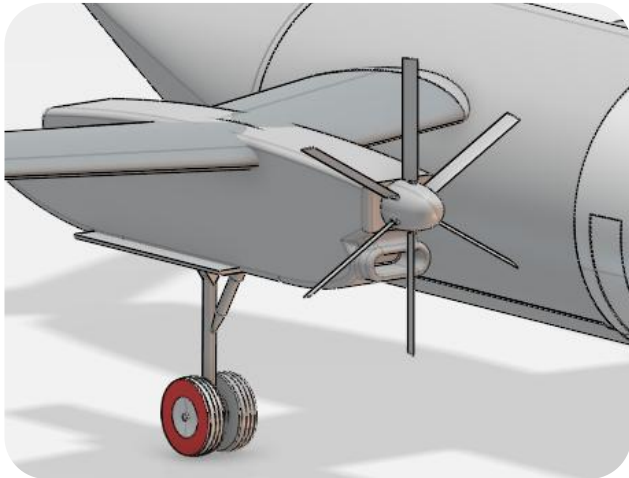

2 Twin-Turboprop Configuration

PW150

5000 hp/engine

Integrated Landing Gear



# ISO-Plane, Technology review



20' Container

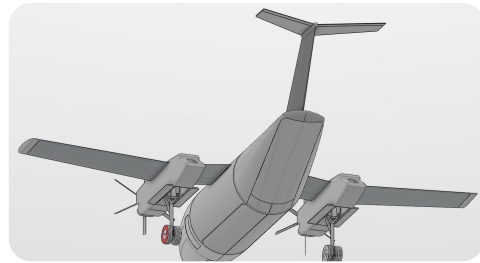

Ventral Doors + Rear doors

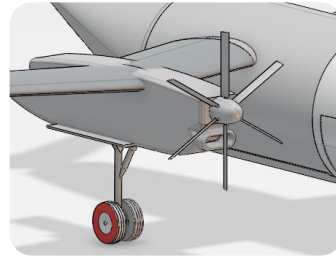

PW150

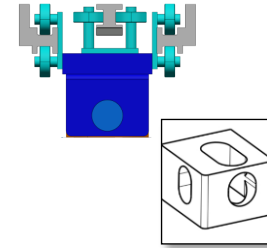

ISO fixation

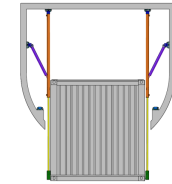

Container crane



ISO-Plane



# Update mar 2026

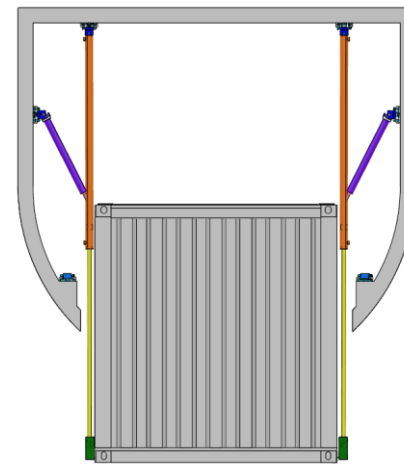
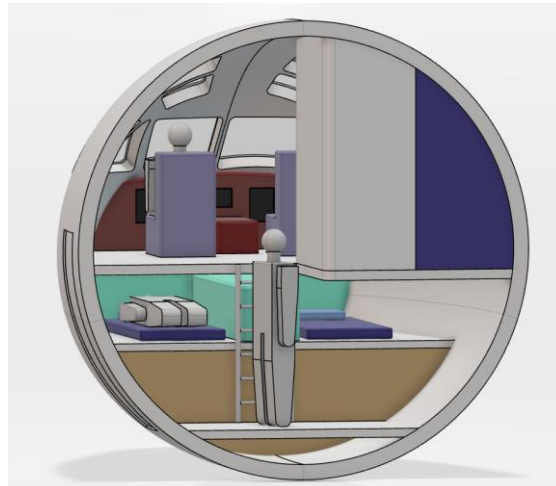
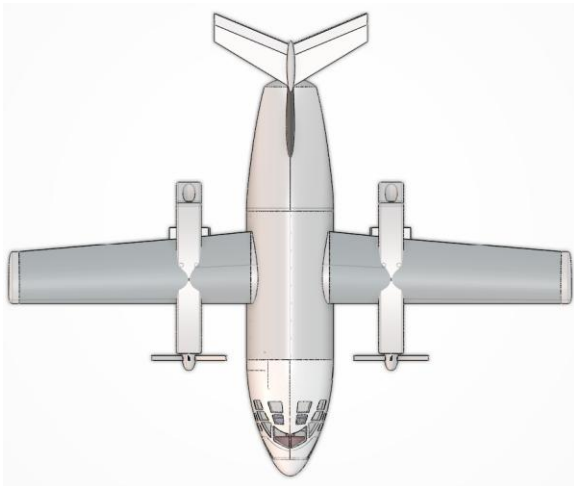
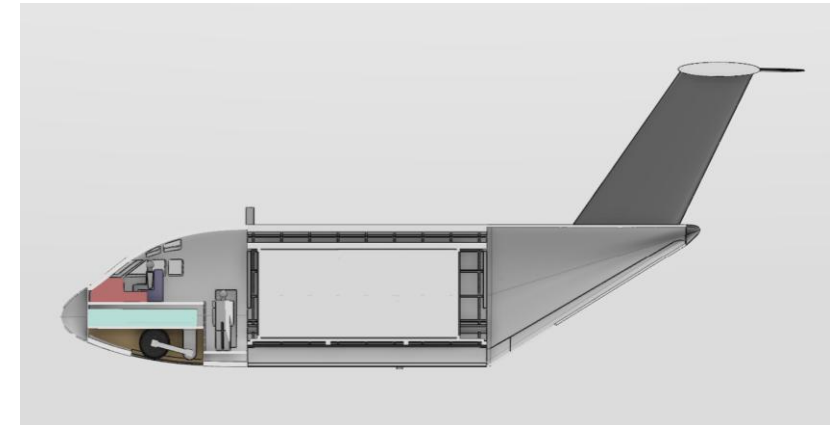
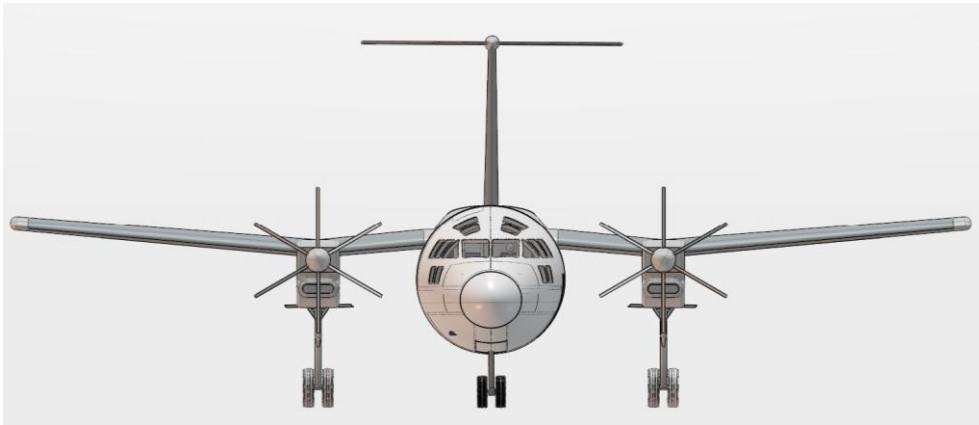

# Join us !

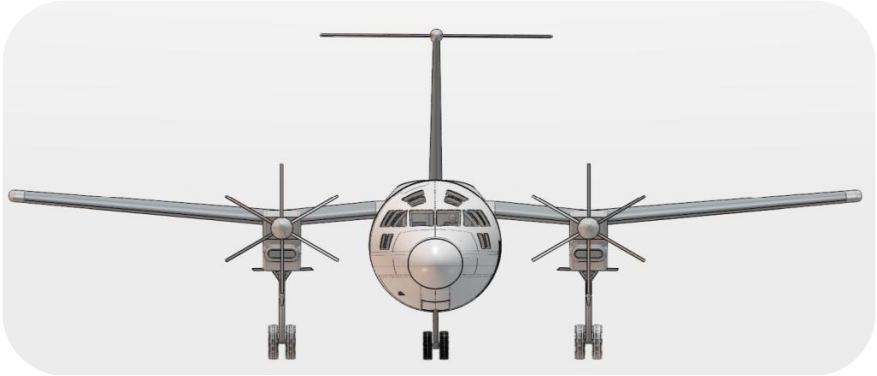

- ISO-Plane
- collaborative project

